



Woodward

frogged brick in two distinct finishes - smooth and antique

HEIGHT



65

Millimetres

FINISHES

Sm

Smooth

Ant

Antique



215 x 65 x 102.5mm

SUSTAINABILITY

Energy Use	100% renewable
Water Used	100% rain water harvesting
Recyclable	100% of this product can be recycled
Manufacturing	Produced in the UK using responsibly sourced materials
Waste Wood + Plastic:	100% recycled
BREEAM	'A+' Rating – in accordance with the BRE Green Guide to Specification.

Information for a specific colour is available on request from our Technical Specification Department.

ADVICE + GUIDANCE

For advice and guidance on ordering, installation, good site practice, etc. visit our website: www.ag.uk.com/advice+guidance

For maintenance guidance and health and safety advice visit our website: www.ag.uk.com/maintenance

FEATURES + BENEFITS

- Available in two finishes - a smooth finish with crisp edges for a contemporary look; and an antique finish with rumbled edges for a more traditional look.
- Woodward bricks are frogged, so they are lighter and easier to handle than solid bricks.
- The frog creates an extra recess for the mortar, resulting in a stronger bond between bricks.
- Frogged bricks reduce the environmental impact as the indentation in the brick saves on materials, which also helps reduce the curing time of the bricks.

AG RECOMMENDATIONS

Frog
Woodward bricks should be laid with the frog facing upwards and completely filled with mortar.

Colour blending
Products should be mixed on site from a minimum of 3 packs to help reduce the effect of banding.

Mortar Ratio
Recommended ratio 6 : 1 or 5 : 1 (Sand : OPC).

EDGES

Woodward Brick is supplied with either crisp, clean edges (smooth finish) or distressed, round edges (antique finish).

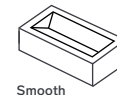

Smooth

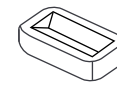

Antique

FINISHES

Woodward Brick comes in two finishes.

Smooth for a contemporary feel and a chic, modern look.

Antique with the rumbled, distressed finish of old reclaimed brick and all of the benefits of new brick.

SPECIFICATION REFERENCE: NBS PLUS: F10 BRICK/ BLOCK WALLING 215 CONCRETE FACING BRICKWORK; hEN 771-3 : 2011 + A1 : 2015

ENVIRONMENTAL PRODUCT DECLARATION (EPD)

An EPD is a comprehensive document that quantifies the environmental impact of a product or range over its entire life cycle.

At AG we exist to develop and create the most sustainable paving and building products available today.

Read more about AG's commitment to sustainability [here](#), download our Corporate Social Responsibility (CSR) brochure [here](#) and download our latest EPDs [here](#).

Product Finish	GWP Total A1-A3, C1-C4 + Scope D kgCO2e per m2	GWP Total A1-A3, C1-C4 + Scope D kgCO2e per m3
Smooth	17.36	170
Antique	21.02	206



Woodward

frogged brick in two distinct finishes - smooth and antique

HEIGHT



65

Millimetres

FINISHES

Sm

Smooth

Ant

Antique

215 x 65 x 102.5mm

Woodward stock information

STOCK INFORMATION

Product type	Length (mm)	Depth (mm)	Height (mm)	In Stock	Available Colours	Units per pack	Unit weight (kg)	Weight per pack (t)	Packs per 8 wheeler (Ireland)	Packs per unit lorry (GB/Ireland)
FACING BRICK	215	102.5	65	YES	Clarendon Blue Smooth / Durrow Cream Smooth / Durrow Cream Antique / Edenmore Smooth / Edenmore Antique / Lewis Smooth / Lewis Antique / Oldtown Multi Smooth / Oldtown Multi Antique / Shandon Smooth / Shandon Antique	512	2.9	1.55	10	GB 18 / IRE 16
				MTO	Ashbrooke Smooth / Ashbrooke Antique / Clarendon Blue Antique / Doonmore Smooth / Doonmore Antique / Hampton Smooth / Hampton Antique / Harland Blend Smooth / Harland Blend Antique / Lyndhurst Smooth / Lyndhurst Antique / Olde Dublin Buff Smooth / Olde Dublin Buff Antique / Tullamore Smooth / Tullamore Antique / Vintage White Smooth / Vintage White Antique / Wicklow Smooth / Wicklow Antique					

NB. In stock items requiring over 10,000 no. bricks are treated as made to order.
 MTO - made to order (minimum order size 10,000 no. bricks).
 All bricks are supplied on pallets.
 All size dimensions are nominal.



Frost Resistant



Very Low Risk of Efflorescence



Very Low Water Absorption



Specials Available

TECHNICAL INFORMATION

MANUFACTURING STANDARD	hEN 771-3: 2011+A1 : 2015 Attestation Level 2+ Category 1	THERMAL CONDUCTIVITY	1.56 W / m.K
COMPRESSIVE STRENGTH*	Min average 22 N/mm ²	INITIAL RATE OF ABSORPTION	0.42 Kg / m ² .m-1
WATER ABSORPTION (24HR)	6% max	BOND STRENGTH	0.15 N / mm ²
DURABILITY DESIGNATION	F2 Severe Exposure	REACTION TO FIRE	A1 Class
MEAN COEFFICIENT OF WATER ABSORPTION	4.4 g / (m ² .s)	TYPE OF MORTAR	Recommended ratio 6 : 1 or 5 : 1 Sand : OPC
MOISTURE MOVEMENT COEFFICIENT**	0.46 mm / m	WATER VAPOUR PERMEABILITY [u]	5 / 15u tabulated from EN 1745
ACTIVE SOLUBLE SALTS [SO3]	0.03%	PACK QUANTITY	512
SIZE TOLERANCE	hEN 771-3: 2011 (T1) Category D2	PACK SIZE [APX. MM]	L 850 x D 850 x H 1100mm
GROSS DENSITY	2200 Kg / m ³	TYPICAL PACK WEIGHT	1550 Kg
		PACKAGING (FULL SHRINK BAG)	Pallet

* Compressive strength in accordance with PD 6697 : 2010 and Eurocode 6.

** Determination of moisture movement and drying shrinkage carried out in accordance with hEN 772-14:2001 (E)

Enduur 1

Enhanced colour and reduced efflorescence.

Enhanced mix which increases strength, resistance to wear and tear, longevity and vibrance.

30% less embodied carbon than a kiln-fired clay brick.

Helps prevent moss and algae growth and deep staining.

